

FISHER PRICE DE CELL
MAGNAN EDISON # WFF 66705

250W POST TOP UNIT W/ 120/240
CONSTANT WATTAGE BALLAST
NO GRAY EDISON # LMAAD 12 E
OR LMAAD 4 F. SEE PLAN FOR
DISTRIBUTION TYPE

W/ 250W SOURCE
SACRED 1/2" DIA
COVER COVERS EVERY
OTHER POLE (SEE PLAN)

4" ALUM. ANCHOR BASE POLE
M5 GRAY EDISON # WAP-5

ANCHOR BOLTS BY E.C.
CADWELD 1/2" WIRE TO POLE BY E.C.

10 # 16 GA. GROUND WIRE BY E.C.

GROUND WIRE TO POLE BY E.C.

CONDUIT WIRING BY E.C.
CONV. W/ 1/2" DIA. UNFINISHED

10 # 16 GA. COPPER CLAD GROUND WIRE
BY E.C.

CONCRETE BASE BY E.C.

DETAIL A

X F.M.E. BY C.E.I. CO.

WEATHER HEAD
BY E.C.

CONDUIT & SECONDARY
BY E.C.
3/4" THW-1/2" C.

ELECTRICAL CONTR. SHALL
FURNISH & INSTALL 12" DEEP W.P.
METAL ENCLOSURE W/
LOCKABLE DOOR AND COVER

100/2P W/P FUSED SW
(NEMA 12) BY E.C.

METERING BY C.E.I. CO.

TIME SWITCHES BY E.C.
FRANCON SERIES AND
SPST AG-140V-1/2" H.H.
OUTDOOR

1P. OL. 120/240V-10-3W
L.T.B. - PUSHMATIC LOAD
CENTER - 1/2" AMP. N.L.O.
W/ SIGHT ENCL. (BY E.C.)

CONDUITS TO L.T.B. & SW. SEE PLAN

WOODEN POLE
AS REQUIRED

FINISHED GRADE

CADWELD

10 # 16 GA. CU CLAD
GEO. WIRE (BY E.C.)

DETAIL B

X F.M.E. BY C.E.I. CO.

METERING BY C.E.I. CO.

NEMA 12 ENCLOSURE

100/2P FUSED SW

3/4" THW-1/2" C.

WEATHER HEAD

E.C. TO PROVIDE SUFFICIENT
TAILS FOR CONNECTION

1P. OL. 120/240V-10-3W

11-10A-1P

11-10A-2P

10-10A-1P

11-20A-1P

2 SPACES

NEMA 12

POST TOP UNITS

SIGN

RECEPTACLES

120/240V-10-3W ONE LINE DIAGRAM

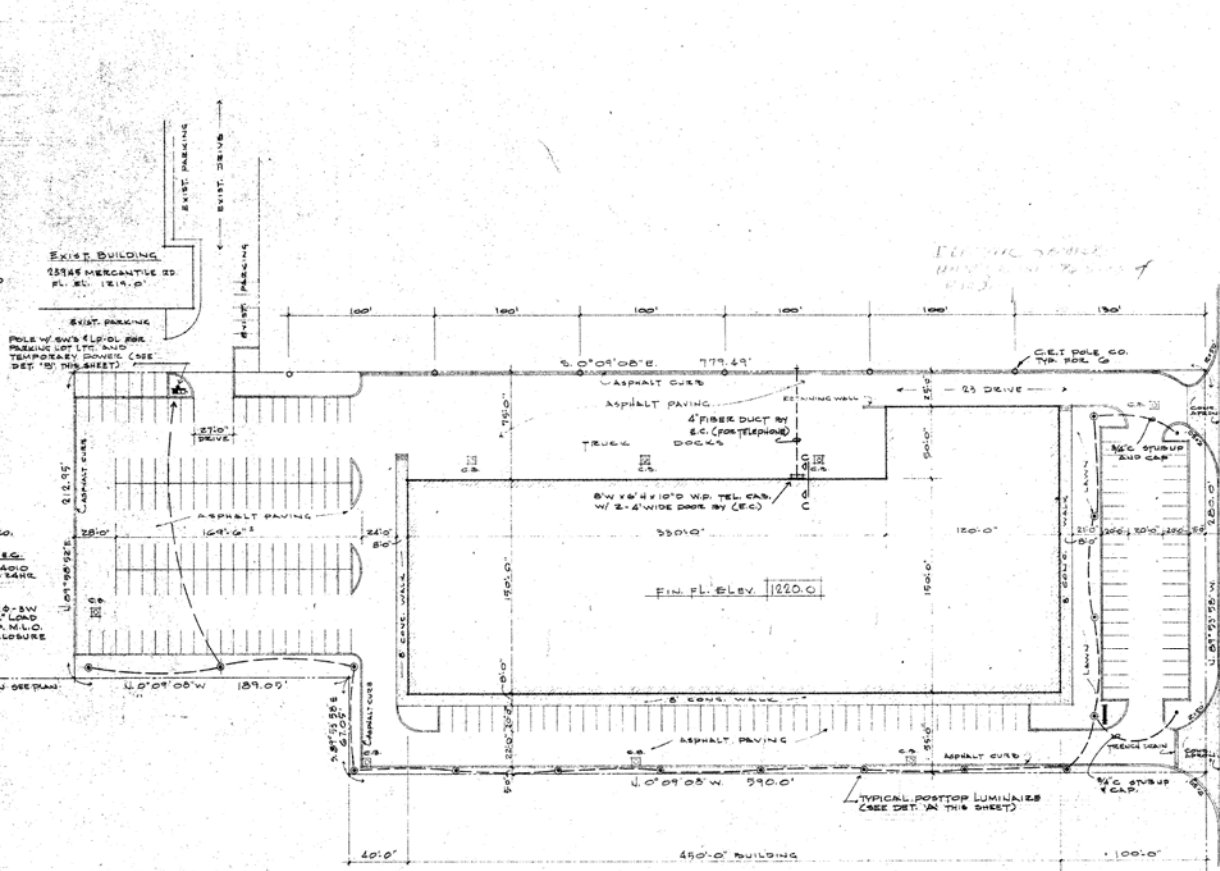

SITE PLAN SCALE 1"=40'0"



THE BLARE CONSTRUCTION CO., INC.
1728 EAST TWENTY THIRD STREET
CLEVELAND, OHIO 44114
AREA CODE 216 PHONE 681-8186

ROBERT I. BROIDA - ARCHITECT
ROBERT V. KELLER - ENGINEER



OFFICE & WAREHOUSE
23645 MERCANTILE ASSOC.
23645 MERCANTILE RD.
BEACHWOOD OHIO

JOB NO. 6935
DATE 20 Feb 74

REVISION NO.	

DRAWING NO.
E-1a